



**PART NUMBER(S)**      **999B1 J6000**  
**REQUIRED FOR**  
**INSTALLATION:**

**KIT CONTENTS:**

Item	Qty.	Part Description	Service Part Number
A	1	Rear Bumper Protector Clear Film	Available as Kit only/Kit PN# 999B1 J6000
B	1	Plastic Squeegee	
C	1	Squeegee Sleeve	
D	1	Installation Instruction Website Address	

**TOOLS REQUIRED:**

- 90% Isopropyl Alcohol
- Soft Lint Free Microfiber Cloth
- Water
- 32 Ounce Spray Bottle
- Dish Soap

**INSTALLATION CAUTIONS:**



## CAUTION

- Dealer installation recommended. Instructions may refer to Service Manual.
- Please read this instruction carefully before installing this product for correct installation.
- Please **DO NOT** use or install the part in ways other than what is described.
- Application Solution: Fill 32 oz. spray bottle with 20% isopropyl alcohol, 80% water and add 5-7 drops of dish soap.
- Thoroughly wash vehicle with soap and water prior to installation.
- Take care not to scratch or damage any component during the removal or re-installation process.
- Avoid installing product in direct sunlight, in windy conditions, or near debris producing operations (ie: spray painting, blowing leaves, mowing lawn).
- Make sure your hands are clean and free from any contaminants that can transfer to adhesive.
- Use tabs when handling protective film so no fingerprints are left on adhesive.
- Vehicle body and protective film should be at 18° to 32° (65°F to 90°F) for optional installation.
- Avoid washing vehicle and exposure to moisture for 24 hours after protective film installation.
- If a problem occurs during installation, please contact Nissan dealer where you purchased the product.

# CAUTION

The Accessory Service Film Protector (999B1 J6000) is for use only with Genuine Nissan or Nissan-Approved accessories. Nissan/Infiniti is not liable for loss or damage due to improper installation or installation of non-Genuine or non-Approved accessories.

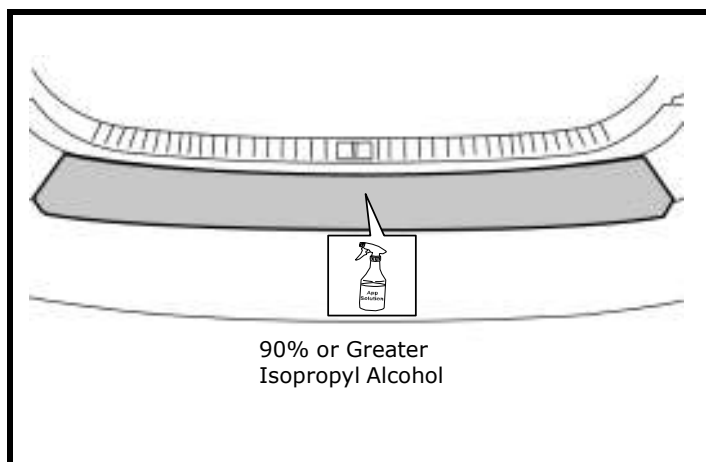

## 1.1) Clean application Surface Area

- a ) Open trunk; using clean lint free microfiber cloth, clean application area of bumper with 90% or greater isopropyl alcohol to allow part to slide freely for alignment. Allow area to dry completely.

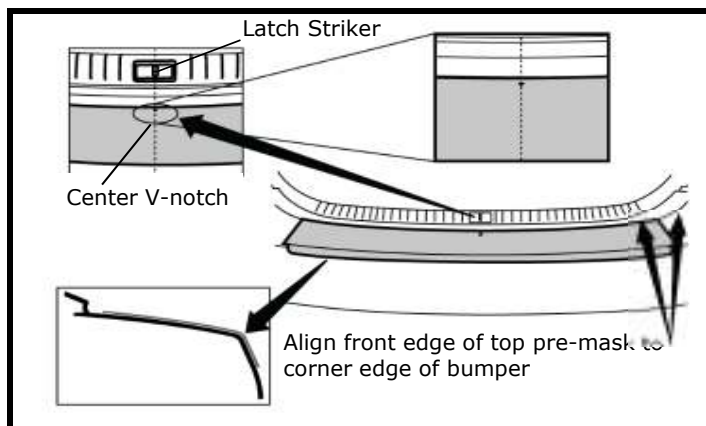

## 1.2) Dry Fit Installation

- a ) Dry fit part before installation to gain familiarity with alignment features. Align V-notch to latch striker and front edge of top pre-mask to top corner edge of bumper.

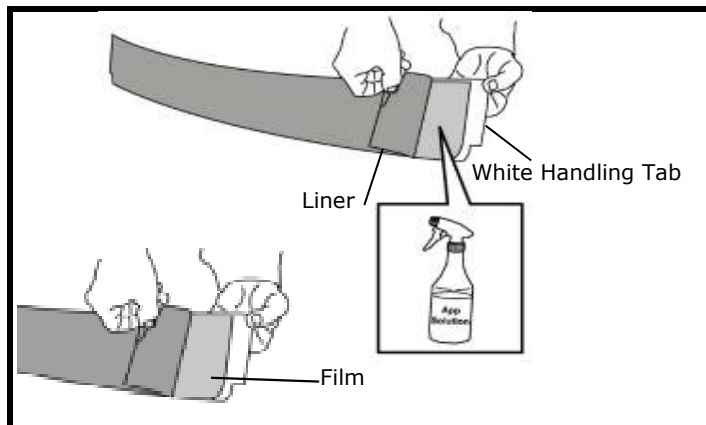

## 1.3) Removing Liner from protective film

- a ) Lay part film face down on clean flat surface for support, such as table.
- b ) Slowly peel bottom white liner from part. use any of handling tabs to steady part as liner is peeled back. Switch handling tabs as needed and avoid contact with adhesive.
- c ) Spray adhesive side lightly with an even mist of application solution. Take care in extreme heat not to allow application solution to dry.

## SECTION 1 - ACCESSORY INSTALLATION PROCEDURE

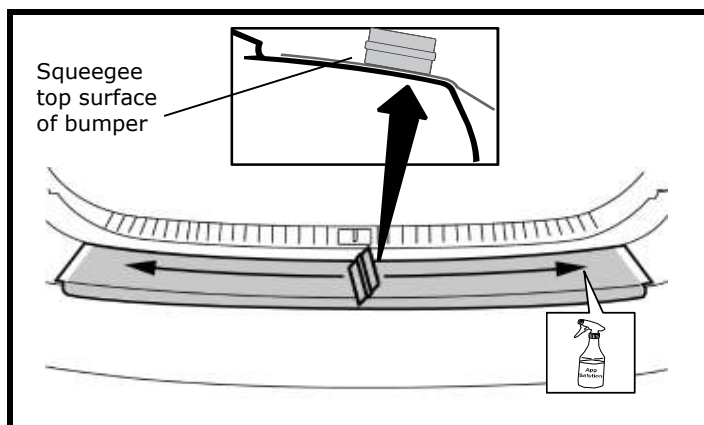

- 1.4) Apply film part to rear bumper
  - a ) Align V-notch to latch striker and front edge of top pre-mask to top corner edge of bumper. Refer to Fig. 1.2
  - b ) Spray top surface of pre-mask lightly with an even mist of application solution.
  - c ) Starting from center of top surface, squeegee outward towards right, moving across in 75 mm (3 inches) increments until end is reached. Use firm lateral overlapping strokes with a pulling down force only. Repeat in opposite direction.

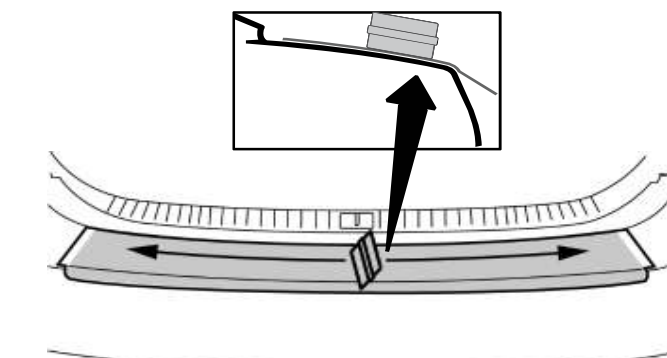

- 1.5) Apply film part to rear bumper
  - a ) Always apply firm pressure as you squeegee. As liquid is pushed outward from edges, always use lint free microfiber cloth to absorb it so that it does not reenter underside of part.

### NOTE:

**To prevent adhesive from sticking prematurely, regularly lift areas of part that have not been squeegeed into position to lightly reapply application solution to adhesive and attachment area of bumper.**

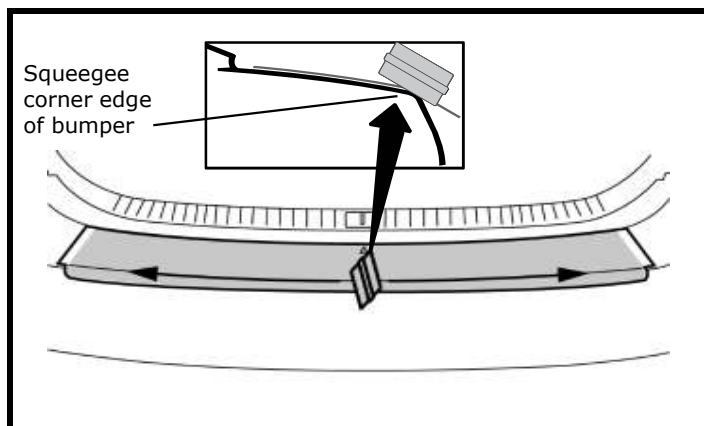

- 1.6) Apply film part to rear bumper
  - a ) Squeegee only along corner edge. Do not tack part to low surface yet. Starting from center, squeegee outward to right using firm lateral strokes until end is reached. Repeat in opposite direction.

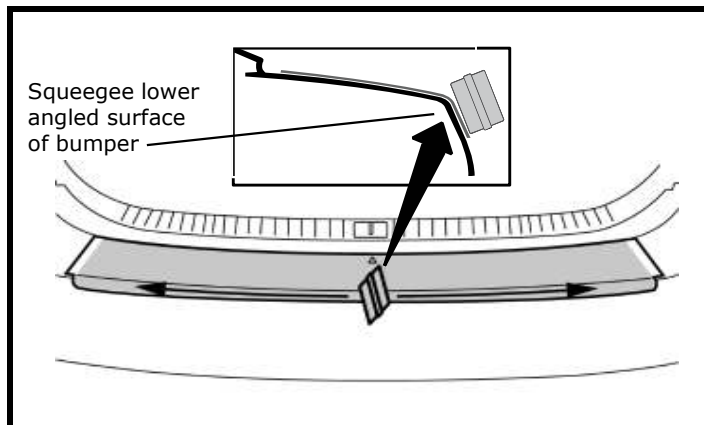

- 1.7) Apply film part to rear bumper
  - a ) Along lower angled surface, use squeegee to smooth out an area about 75 mm (3 inches) to both left and right of part's centerline.  
Starting from center of lower angled surface,
  - b ) squeegee outward towards right, moving across in 75 mm (3 inches) increments until end is reached. Repeat in opposite direction.

### NOTE:

**Inspect entire part for bubbles and spots that have lifted. Re-squeegee troublespots.**

## SECTION 1 - ACCESSORY INSTALLATION PROCEDURE

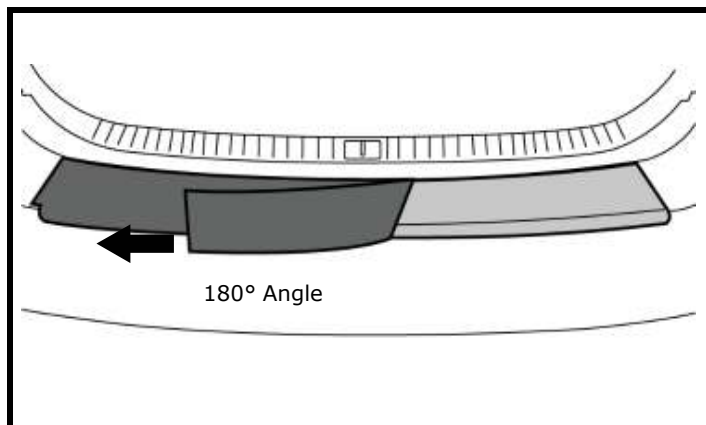

### 1.8) Removing Pre-mask

- a ) Remove premask (top liner) by pulling slowly and horizontally at 180° angle back against itself.

**NOTE:**

**Do not pull downward, if corner of film lifts when trying to remove pre-maskk, re-squeegee and let it dry a few minutes before trying again.**

- b ) Wipe part and surrounding area of rear bumper with lint free microfiber cloth.