



GENUINE PARTS

INSTALLATION INSTRUCTIONS

DESCRIPTION: Splash Guard-Rear

APPLICATION: QX50

PART NUMBER: T99J2 5NA2A

KIT CONTENTS:

Item	Qty.	Part Description	Service Part Number
A	1	Splash Guard - Rear Right	T98J2 5NA4A
B	1	Splash Guard - Rear Left	T98J2 5NA3A
C	2	Push Pin	11296-AG000
D	6	Philips Head Screw - 20mm	14-51 00891
E	6	Spring Clip	12-41 0012U
F	1	Installation Instruction Replacement Template	N/A

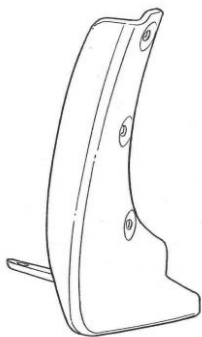

A

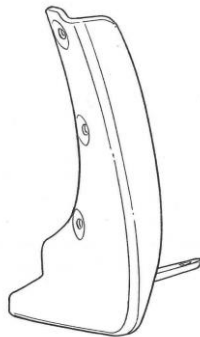

B



C



D



E



F

TOOLS REQUIRED:

- Clean rag
- Soap & water
- #2 Phillips screw driver
- Drill
- 6mm (1/4") Drill Bit
- Awl

PRE-INSTALLATION WARNINGS, CAUTIONS, CRITICAL STEPS, and NOTES:

- These installation instructions are for the left side of the vehicle; the same procedure applies to the right side.
- Dealer Installation Recommended.
- Parts to be installed at room temperature.

INSTALLATION PROCEDURE:

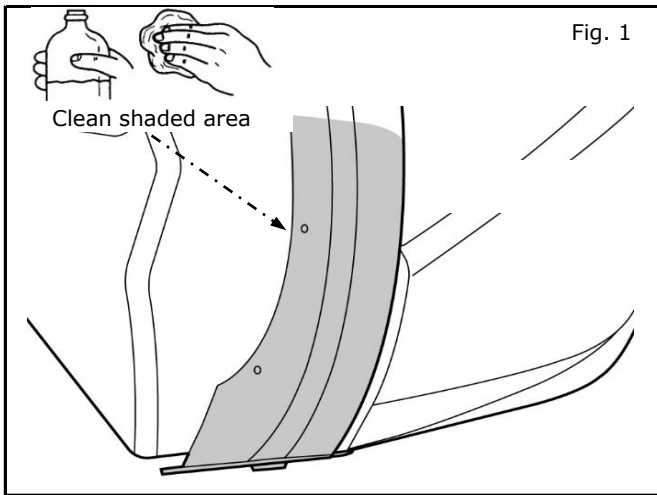

- 1) Clean shaded area with soap and water mixture and dry.

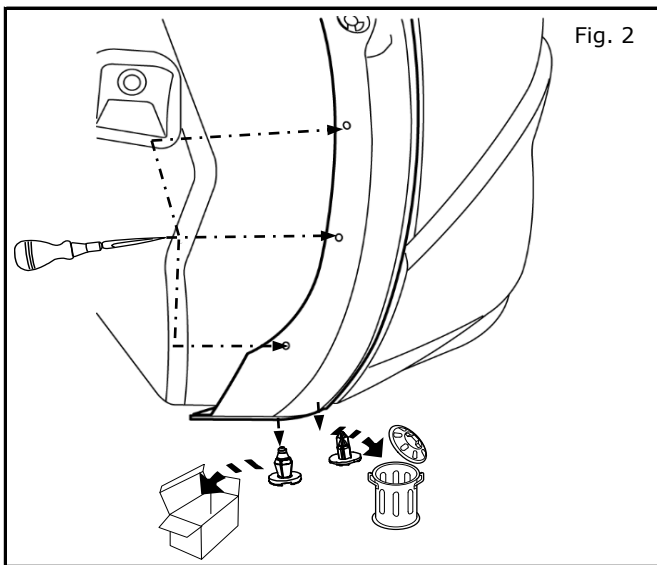

- 2) Remove 2 push pins. Keep front push pin and discard rear push pin.
- 3) Mark center of 3 scribed circles with awl.

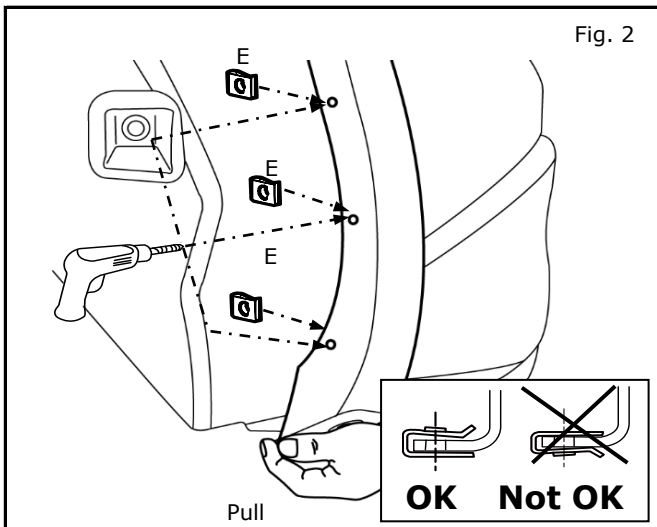

- 4) Pull out and twist fender flare end and drill 6mm (1/4") hole in 3 marked locations.
- 5) Install supplied spring clip (E) over drilled 3 holes.

INSTALLATION PROCEDURE: (continue)

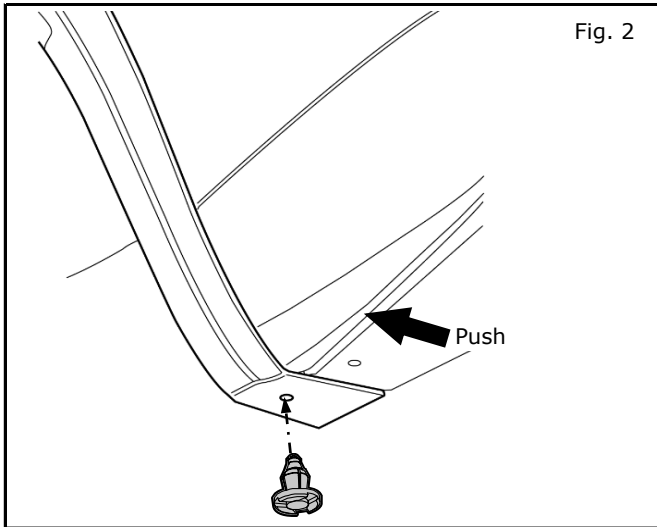

- 6) Push trim back, reinstall forward push pin.
- 7) Mark center of 3 scribed circles with awl.

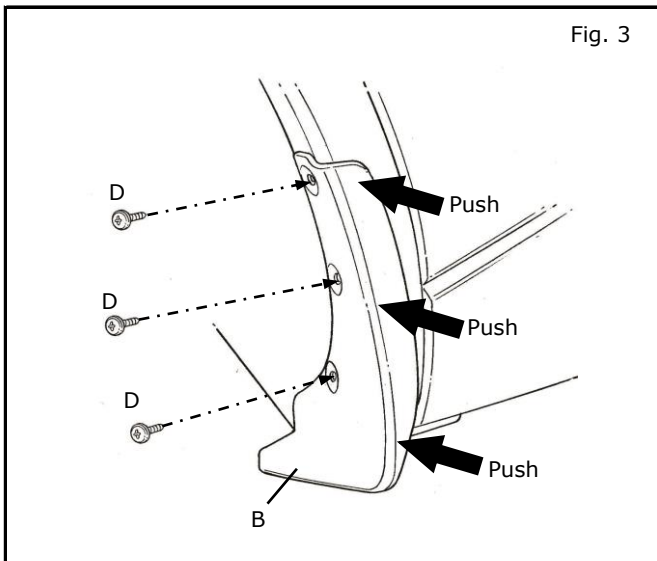

- 8) Align rear splash guard (B) to vehicle.
- 9) Hold splash guard up and into vehicle and install 3 supplied screws - 20mm (D).
NOTE:
Do not over tighten screw. Reference Tighten Torque: 3.8~4.4N-m {34~39 in-lb}

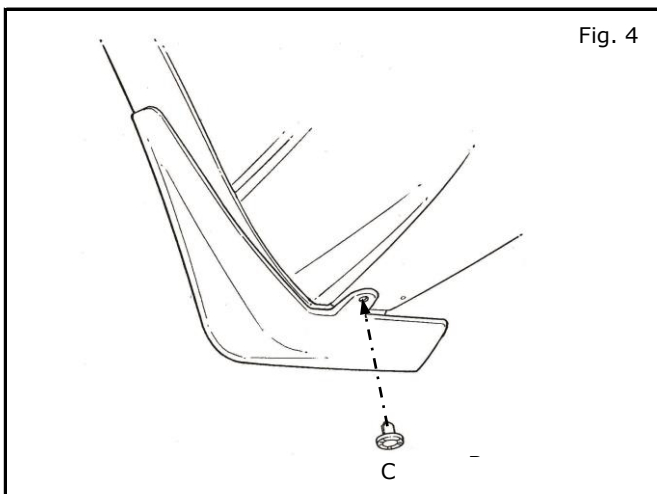

- 10) Install supplied push pin (C).