



GENUINE PARTS

INSTALLATION INSTRUCTIONS

DESCRIPTION:	Rear Bumper Protector - Clear
APPLICATION:	Infiniti Q60
PART NUMBER:	T99B1 5CH0A

KIT CONTENTS:

ITEM	QTY	Part Description	Service Part Number
A	1	Rear Bumper Protector Film	N/A
B	1	Plastic Squeegee	N/A
C	1	Squeegee Soft Sleeve	N/A
D	1	Installation Instruction Replacement Template	N/A

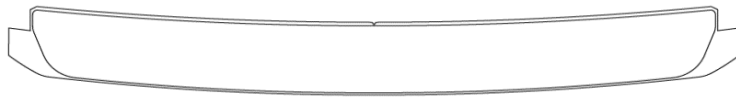

A

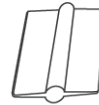

B

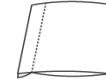

C

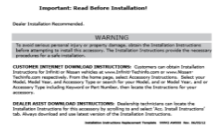

D

TOOLS REQUIRED:

- 90% Isopropyl Alcohol
- Dish Soap
- 32 Ounce Spray Bottle
- Water
- Soft Lint Free Microfiber Cloth
- Pin

PRE-INSTALLATION WARNINGS, CAUTIONS, CRITICAL STEPS, and NOTES:

- Dealer Installation Recommended.
- **Application Solution:** Fill a 32 oz. spray bottle with 25% isopropyl alcohol, 75% water, and add 5-7 drops of dish soap.
- Install in a clean, non-dusty environment.
- Avoid installing product in direct sunlight, in windy conditions, or near debris producing operations (ie: spray painting, detailing, blowing leaves, mowing lawn).
- Thoroughly wash vehicle with soap and water.
- Make sure your hands are clean and free from any contaminants that can transfer to adhesive.
- Use tabs when handling film so no finger prints are left on adhesive.
- Squeegee must remain inside soft sleeve throughout entire installation process.
- Vehicle body surface and protective film should be at 65°F to 90°F for optimal installation.
- Maintain vehicle body surface temperature of 65°F to 90°F for a minimum of 30 minutes after protective film installation.
- Avoid washing vehicle and exposure to moisture for 24 hours after protective film installation.

INSTALLATION PROCEDURE:

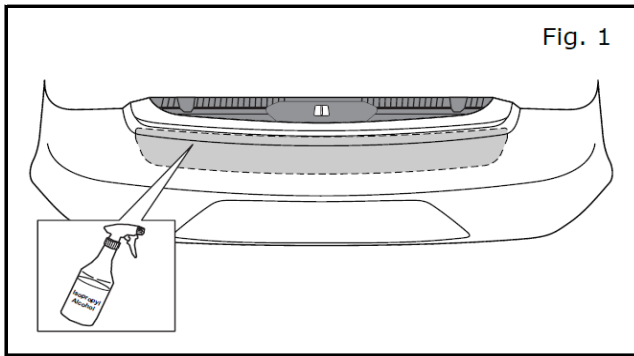

- 1) Open trunk; then, use a clean lint free microfiber cloth to clean surface of bumper with 90% or greater isopropyl alcohol solution. Allow area to dry completely.

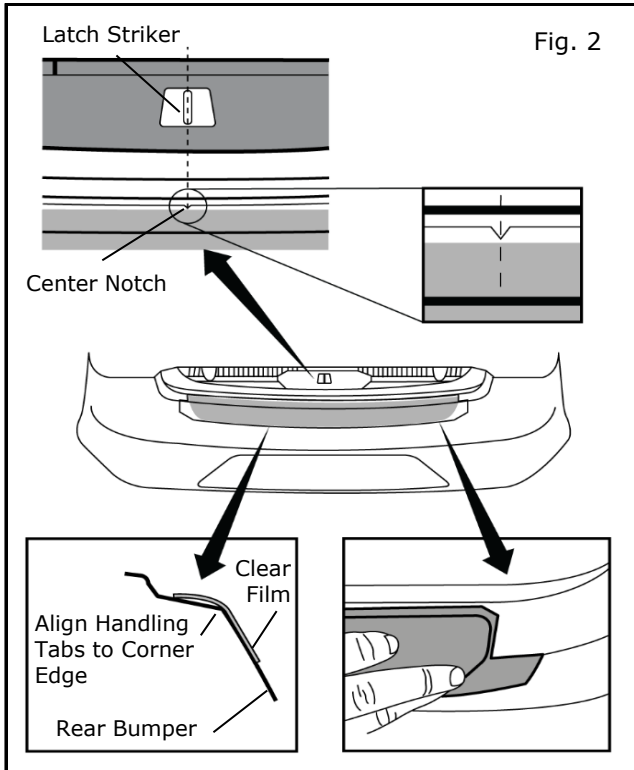

- 2) Dry fit part before installation to gain familiarity with alignment features. Align V-notch to latch striker and front edge of each handling tab to corner edge of bumper. Refer to Fig. 2.

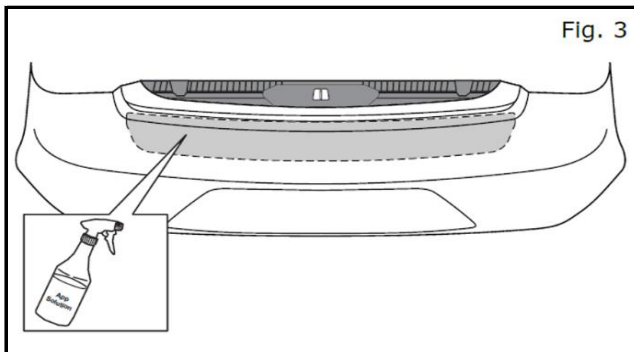

- 3) Spray attachment area of bumper evenly with a light mist of application solution.

INSTALLATION PROCEDURE: (continued)

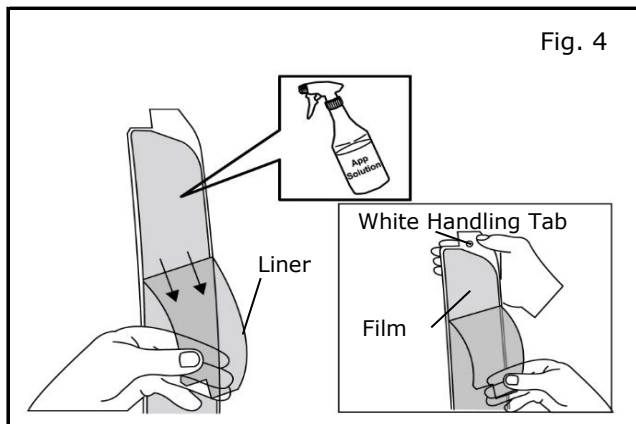

- 4) Wet fingers with application solution to minimize potential for transferring fingerprints to adhesive. Hold white handling tab and remove bottom paper liner. Bottom liner is thicker than top premask.

- 5) Spray adhesive side lightly with an even mist of application solution.

NOTE:

Take care in extreme heat not to allow application solution to dry before part is properly squeegeed into position. Spray on additional application solution to adhesive and/or attachment area of bumper as needed.

- 6) Align V-notch to latch striker and front edge of each handling tab to corner edge of bumper.

NOTE:

Refer to Fig. 2 for part alignment.

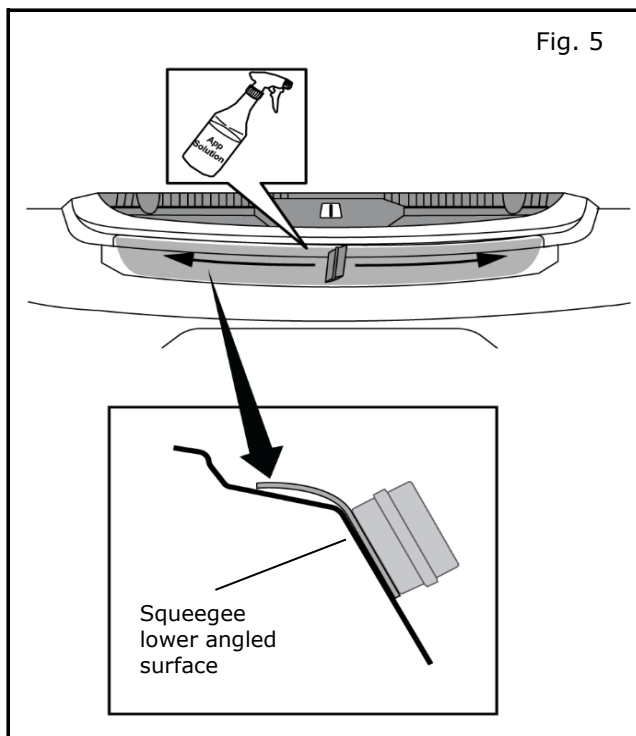

- 7) Spray top surface of premask lightly with an even mist of application solution.

- 8) Part must be tacked to lower angled surface of bumper before beginning to tack part to corner edge and top surface.

- 9) Along lower angled surface, use squeegee to smooth out an area about 75 mm (3 inches) to both left and right of part's centerline. Use firm lateral overlapping strokes only.

NOTE:

Always apply firm pressure as you squeegee. As liquid is pushed outward from edges, always use lint free microfiber cloth to absorb it so that it does not reenter underside of part.

NOTE:

To prevent adhesive from sticking prematurely, regularly lift areas of part that have not been squeegeed into position to lightly reapply application solution to adhesive and/or attachment area of bumper.

- 10) Starting from center of lower angled surface, squeegee outward towards right, moving across in 75 mm (3 inches) increments until end is reached. Use firm lateral overlapping strokes only. Repeat in opposite direction.

INSTALLATION PROCEDURE: (continued)

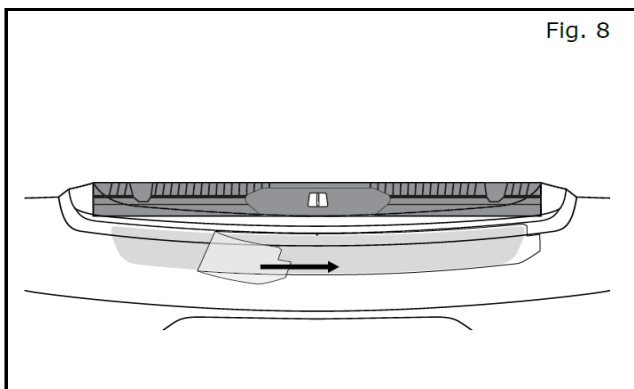
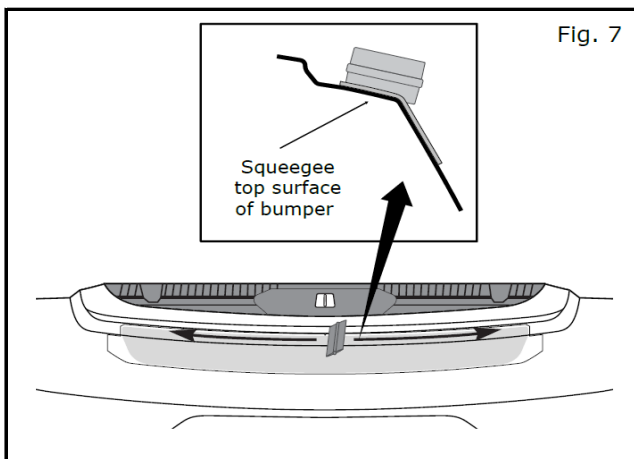
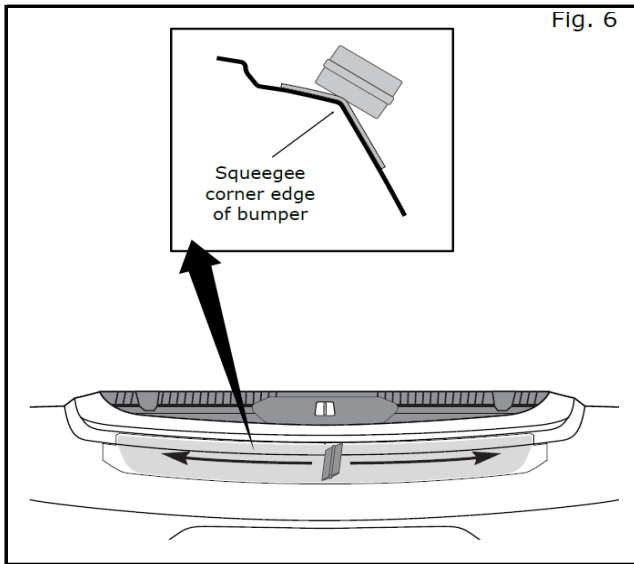

11) Squeegee only along corner edge. Do not tack part to top surface yet. Starting from center, squeegee outward to right using firm lateral strokes until end is reached. Repeat in opposite direction.

12) Inspect lower angled surface and corner edge for bubbles and spots that have lifted. Re-squeegee troublespots. If spots continue to lift after re-squeegeeing, apply firm pressure with your thumb for 30 seconds on each troublespot.

13) Starting from center of top surface, squeegee outward towards right, moving across in 75 mm (3 inches) increments until end is reached. Repeat in opposite direction.

14) Inspect entire part for bubbles and spots that have lifted. Resqueegee troublespots. If spots continue to lift after re-squeegeeing, apply firm pressure with your thumb for 30 seconds on each troublespot. Make sure all air and water is removed from under part.

15) Remove premask (top liner) by pulling slowly and horizontally at 180° angle back against itself.

NOTE:
Do not pull upward.

16) Repeat step 14.

NOTE:
An alcohol and water solution can be sprayed under edges and squeegeed out if edges are not adhering.

NOTE:
If bubbles persist, carefully use a pin to puncture the base of each bubble, squeegee out any air or liquid, and wipe up any liquid with clean lint free microfiber cloth.