



INFINITI

# GENUINE PARTS

## INSTALLATION INSTRUCTIONS

**DESCRIPTION:** Shopping Bag Hook

**APPLICATION:** Q60 Coupe

**PART NUMBER:** 999C2 J2005

**KIT CONTENTS:**

Item	Qty.	Part Description
A	2	Shopping Bag Hook
B	2	Phillips Head Screw #10-24 x 1"
C	1	Hex Head Screw #10-24 x 1"
D	2	Jack Nut #10-24
E	2	Jack Nut Friction Wrench
F	1	Installation Instruction Replacement Template

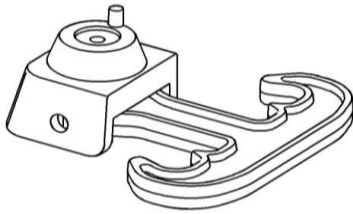

A



B



C



D



E



F

**TOOLS REQUIRED:**

- Phillips Screw Driver
- 3/16" & 3/8" HSS drill bits
- Clip Removal tool or Flat head Screwdriver
- Hammer
- 5/16" Socket
- Cordless Drill
- Knife
- Scissors
- Drop Cloth
- Center Punch
- Tape
- Torque Wrench
- Deburring tool or file

### WARNING

- Each Shopping Bag Hook is designed to transport normal cargo contents. Flammable or dangerous materials should not be transported in your vehicle at any time.
- Do not exceed the recommended load of 15 lbs per Shopping Bag Hook.
- Do not use pilot point drill bits during installation process. These drill bits can leave large burrs and cause enlarged holes. Use HSS drill bits made for drilling steel only.

### CAUTION

- Do not overtighten the Hex Head Screw. Maximum torque is 1.6 to 1.8Nm (14 to 16inlbs).

**INSTALLATION PROCEDURE:**

- 1) Remove (7) push pins from package shelf using a clip removal tool or a flat head screw driver and save to reuse (Fig. 1).

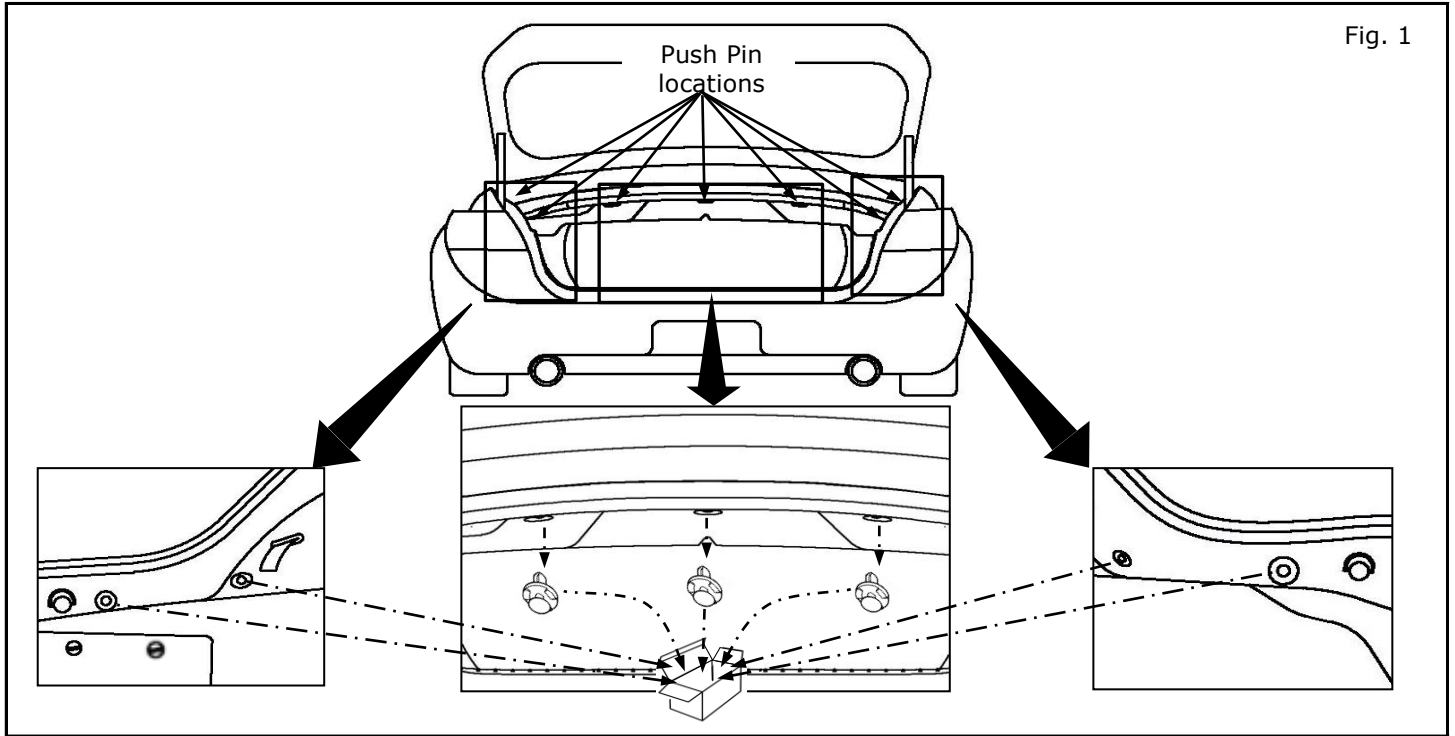

- 2) Place a drop cloth in trunk to catch metal shavings.

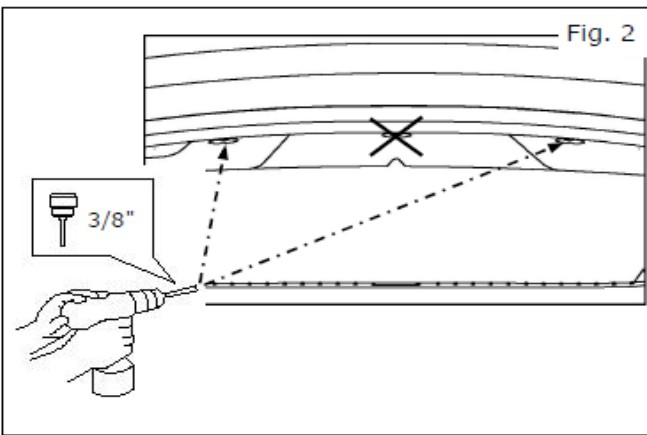

- 3) Drill out (2) push pin holes (see Fig. 2) using a 3/8" HSS drill bit . Do not drill center or outer (4) holes.

**Note:**

**Do not use pilot point drill bits. Use HSS bits for drilling steel only.**

- 4) Pull down trunk trim and remove metal burrs using a deburring tool or file if necessary.

## INSTALLATION PROCEDURE:

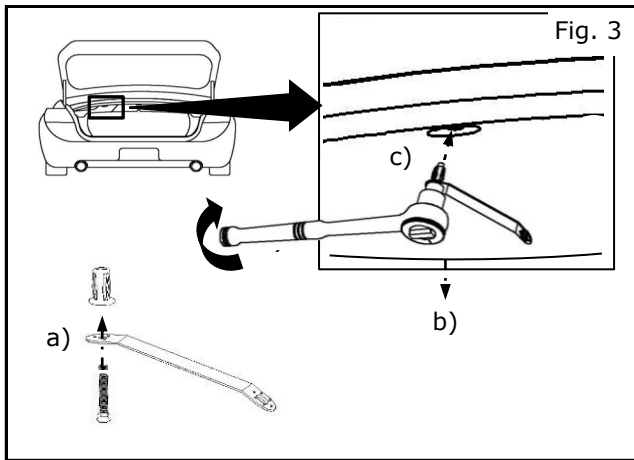

- 5) Attaching Jack Nuts to package shelf.
  - a) Feed hex head screw through large hole in jack nut friction wrench and thread (hand tight) into jack nut.
  - b) Pull down trunk trim.
  - c) Starting with Driver Side push pin hole, insert jack nut/screw assembly into push pin hole, keeping jack nut firmly pressed against sheet metal.
  - d) Use 5/16" socket with a torque wrench and tighten hex head screw in until jack nut is fully collapsed at a maximum between 1.6 to 1.8Nm (14 to 16inlb).
  - e) Remove hex head screw from jack nut and save for passenger side.
  - f) Repeat steps 4a) to 4d) for passenger side and then discard hex head screw afterwards.

### **CAUTION**

- **Do not overtighten the Hex Head Screw. Maximum torque is 1.6 to 1.8Nm (14 to 16inlb).**

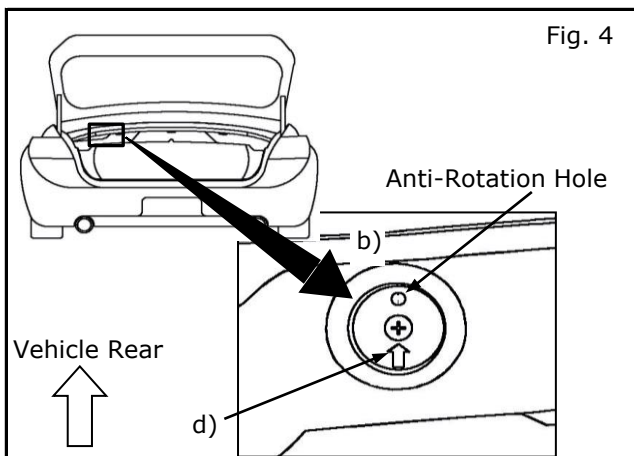

- 6) Align Driver Side Drill Template.
  - a) Go to Page 7, make sure drill template is printed to scale and cut out Driver Side drill template.
  - b) Poke hole in center of template and insert phillips screw.
  - c) Thread phillips screw/template into jack nut.
  - d) Adjust drill template so that arrow is pointing towards rear of vehicle and tighten screw to hold template in place.

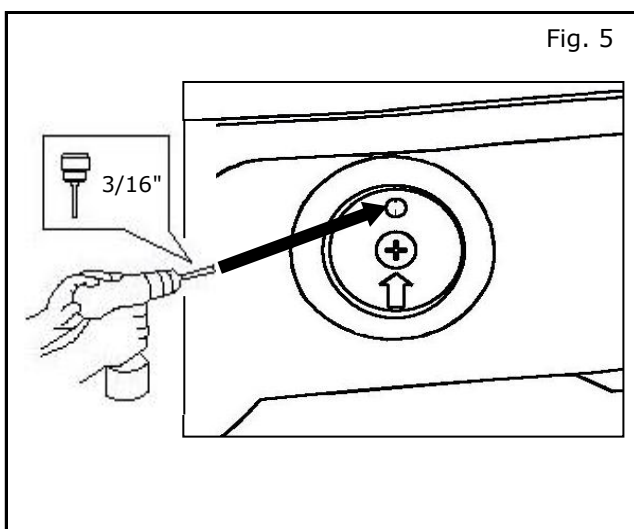

- 7) Mark center of anti-rotation hole with center punch/hammer.
- 8) Remove screw and drill template.
- 9) Drill anti-rotation hole using 3/16" drill bit.
- 10) Pull down trunk trim and remove metal burrs using a deburring tool.

## INSTALLATION PROCEDURE:

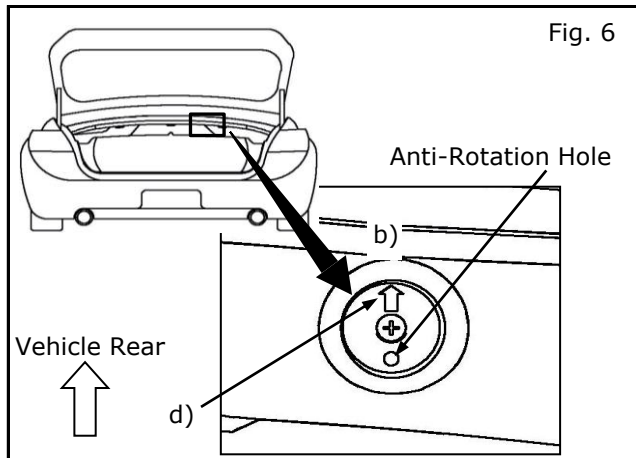

- 11) Align Passenger Side Drill Template.
  - a) Go to Page 7, make sure drill template is printed to scale and cut out Passenger Side drill template.
  - b) Poke hole in center of template and insert phillips screw.
  - c) Thread phillips screw/template into jack nut.
  - d) Adjust drill template so that arrow is pointing towards rear of vehicle and tighten screw to hold template in place.

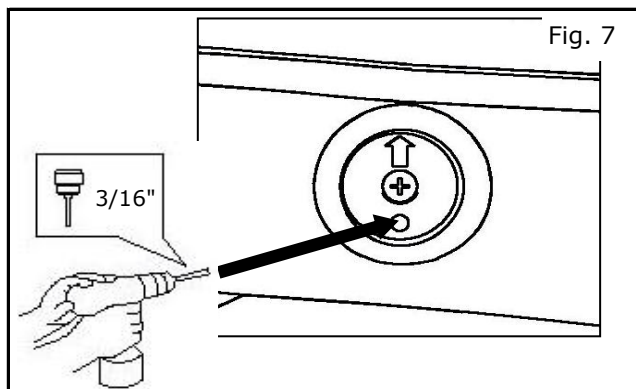

- 12) Mark center of anti-rotation hole with center punch/hammer.
- 13) Remove screw and drill template.
- 14) Drill anti-rotation hole using 3/16" drill bit.
- 15) Pull down trunk trim and remove metal burrs using a deburring tool.

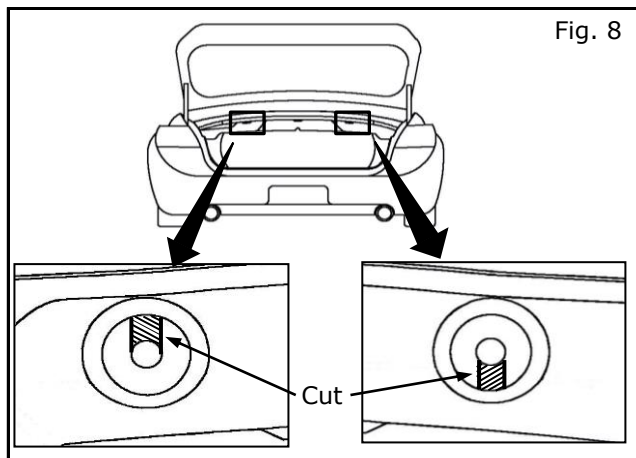

- 16) Make a small cut in trunk trim for anti-rotation pin.

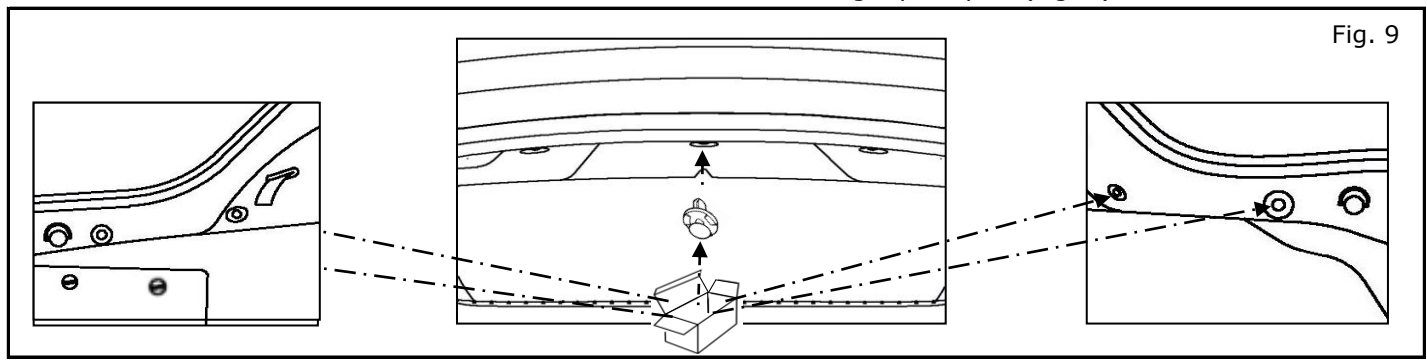

- 17) Push trunk trim back up, reinstall 5 push pins and discard remaining 2 push pins (Fig. 9).

## INSTALLATION PROCEDURE:

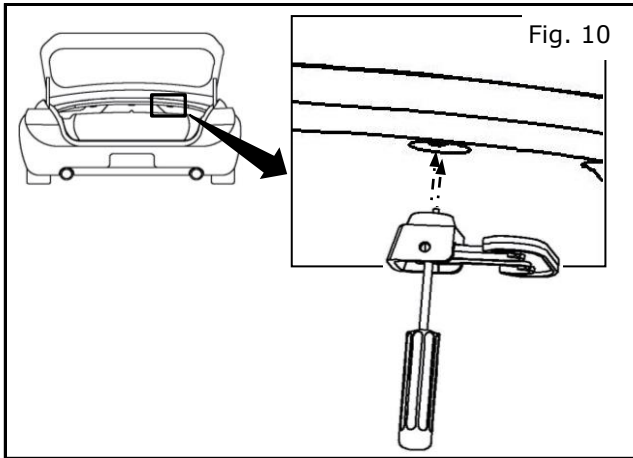

18) Attach Shopping Bag Hook to Package Shelf.

- a) With shopping bag hook in stowed position, insert phillips screw, align with jack nut and anti-rotation hole and fully hand tighten (Passenger side shown).

19) Repeat step 18) for Driver side.

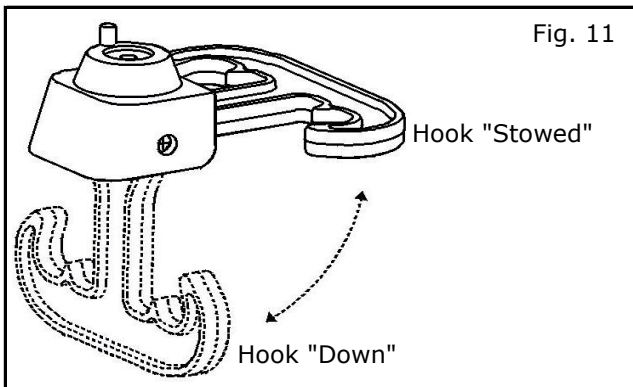

20) Shopping Bag Hook use:

- a) When in use, move shopping bag hooks into "down" position.
- b) When not in use, place shopping bag hooks in "stowed" position.

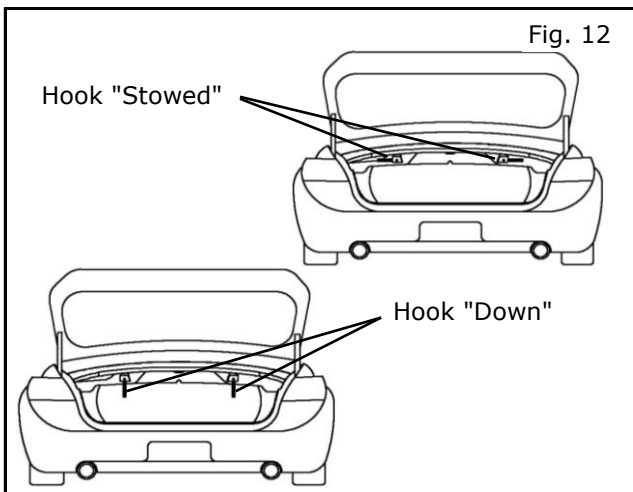

**INTENTIONALLY LEFT BLANK**

**DRILL TEMPLATE:**

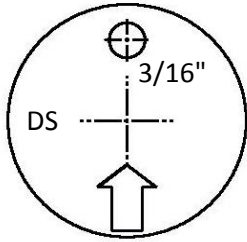

Driver Side  
Drill Template

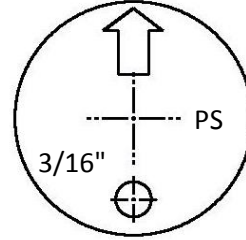
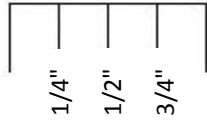

Passenger Side  
Drill Template

